

How to Build Rocket #1

Caution: If you use an Xacto Knife (Round Handle) to cut these parts out, please use something to stop the knife from rolling when placed on the work area. I use some scrap cardstock taped to the handle.

Round handle knives will roll off of the table and stick in your Leg or Foot!

Tools Needed:

- *Work Area
- *Cutting Mat
- *Knife or Scissors
- *Straight Edge (Rulers work great)
- *Embossing Tool. Back edge of a Table Knife (Butter) will work.
- *White PVA Glue (Elmer's Craft Bond All Purpose works great)
- *Some kind of device to apply glue (ink refill syringe, toothpick, paint brush)

Optional Tools Used When Rolling Tubes:

- * 1/4", 3/8" & 5/8"Dia x 3foot Long Wood Dowel
- * Double Sided Tape (permanent-thin width)

When constructing Paper models there are a few things that can make it much easier:

- 1) You need to preshape the part. In the case of the fuselage (tube) it is best to pre-roll and then wrap with a rubberband. Let it set on the work table out of the way. Leave it wrapped until ready to glue it. {I use a short piece of the conduit to roll/wrap, wood dowel works just as well }
- 2) Small parts are easier to complete the scoring of Fold Lines, when still attached to the main sheet.
- 3) Don't use too much glue. Excess glue increases hold/drying time! {I use an ink refill syringe }
- 4) Press hard and hold, to seal the glue joint!!
- 5) The Grey Outlines are cut Lines for the part. Just trace the Outline with a knife or scissors, to remove the part from the main sheet.
- 6) All Dotted Lines (inside the part) are cut lines. Don't cut until the part is ready to be used or told to do so. You don't want to cut them until the part is glued to its final shape or the part will be mis-shaped..
- 7) All Dashed Lines are fold lines, they need to be scored before folding the part. This ensures a good crisp fold.
- 8) It helps to visualize the part before cutting.
- 9) Dry fit all parts before gluing.

HOW TO PRINT:

- No Scaling (Must be printed at 100 %)
 - Center & Rotate
 - Page size by PDF size = 8.5" x 11"
- For cardstock the best is Index 100# but many others will work (65# Cover, 90-110# Index)

General Notes:

- 1) Look for "Alignment" tick marks to help align Tubes & Cones. They are short Grey colored lines near the fit edge of all Cones and Tubes!
- 2) Another method of rolling Cones & the Tubes can be done by rolling the wood dowel over the cone as it is held in the palm of your hand, or over a soft surface such as a mouse pad. Make sure to keep the dowel aimed at the center of the Cone when rolling.
- 3) A complete Build Thread of the Saturn 1B Showing Videos can be seen at the following url
<http://www.papermodelers.com/forum/pasa-paper-aeronautical-space-administration/8542-youtube-saturn-1b-build-thread.html>

No commercial use authorized.

Fuselage Shell

Use the Rocket = Rocket 1 for this Step.

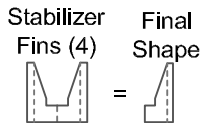
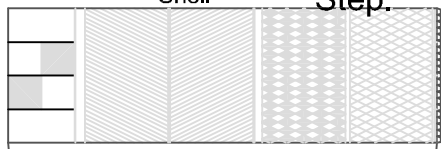

See Page 3

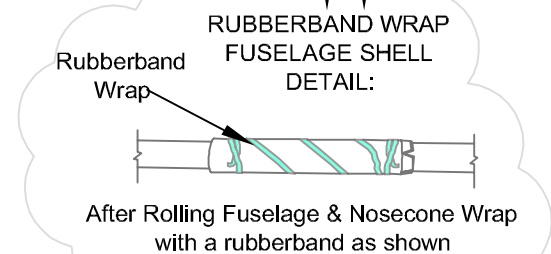
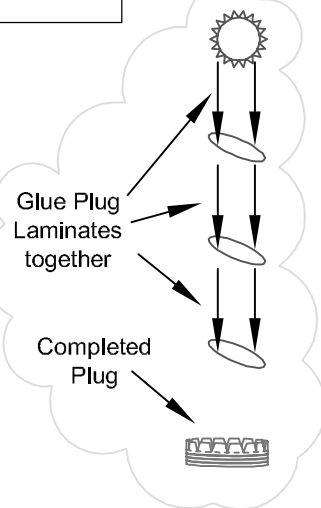
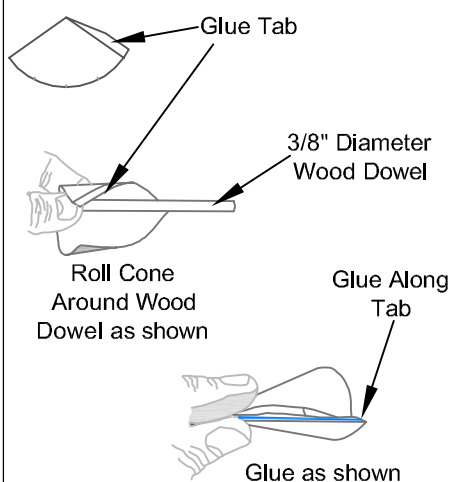
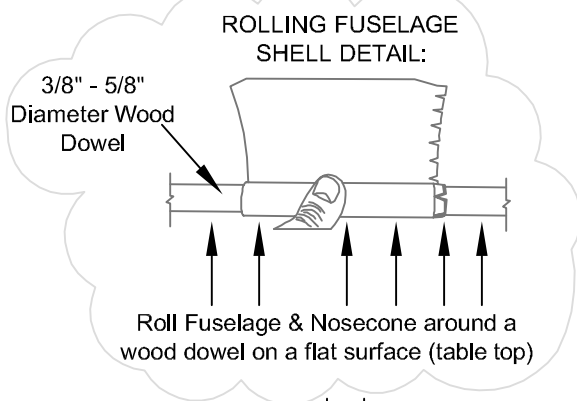
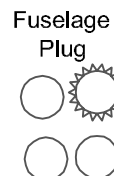
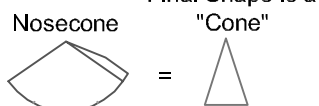

NOTE:
Insert Completed Plug into Fuselage & Glue as shown, set aside to DRY!

Plug must be completely Dry before launching!!

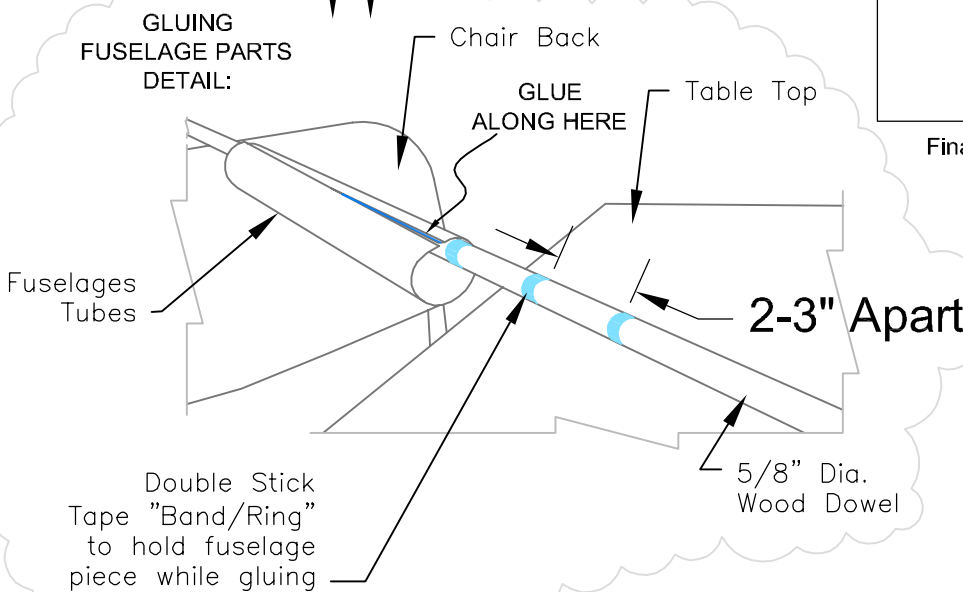
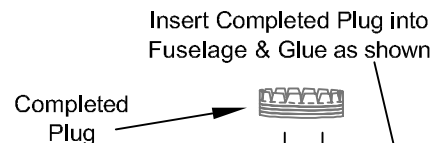

Final shape is a "Tube"

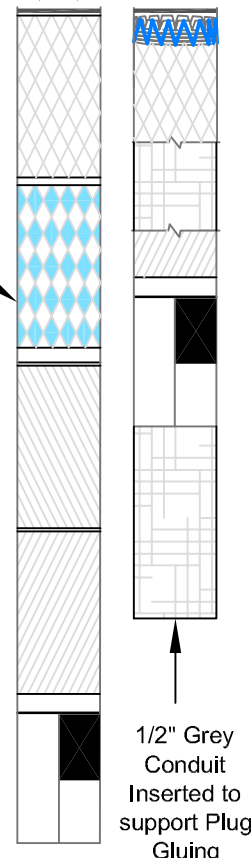

Use the Rocket = Rocket 1 for this
Step.

